

Kit 7880 EC Electric strike

An electrical strike is a good option when you need an electrical keyless control of your door. For example together with a tag-, code- or card system.

Our electrical strike kit includes the lock, lock tube, end sheet tube, brackets for the electric strike, handle, hinges and door stops.

The door blade, cover sheet and the actual electric strike must be added separately to have a complete door.

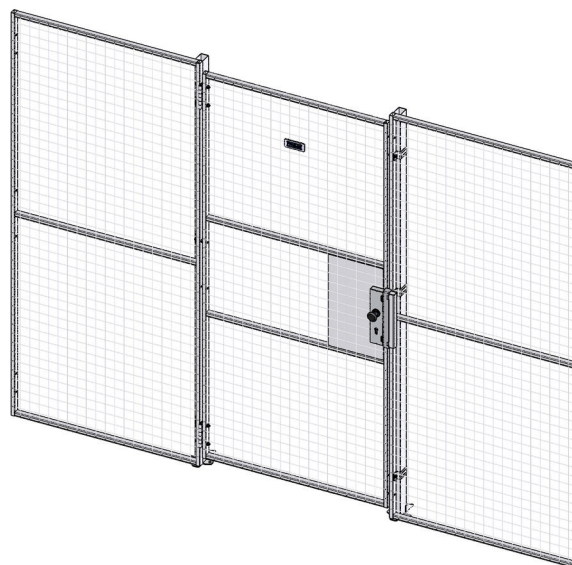

FACTS

Door sizes

| Door Height (mm) | Door Width (mm) |
|------------------|-----------------|
| 2200 | 1000 |
| 2200 | 1200 |

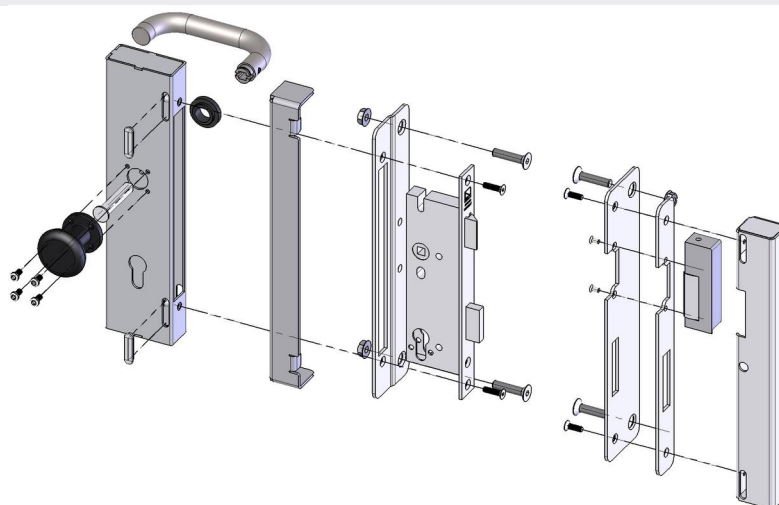

ELECTRIC STRIKES

Compatible electrical strikes

| | |
|----------|---|
| 89100095 | El. strike Solid 114, 24V fail unlocked |
| 89100094 | El. strike Solid 14, 24V fail locked |
| 89100084 | El. strike Solid 11412, 12V fail unlocked |
| 89100085 | El. strike Solid 1412, 12V fail locked |

Termonology

| | |
|---------------|--|
| Fail locked | When power is off, fail locked door is closed! (Solid 14) |
| Fail unlocked | When power is off, fail unlocked door is open! (Solid 114) |

Depending if the customer already have a system for 12/24V
If not choose 24V

